

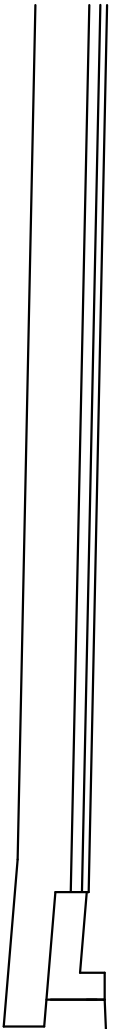

STORM LATERAL DETAIL



PROP. 45° BEND

PROP. WYE

END OF LINE DETAIL

TO BE USED AT THE END OF ALL SUMP PUMP DRAINS.
THE CLEAN OUT WILL BE INCLUDED IN THE COST OF THE 8" PIPE.

8" SDR 35 OR 8" POLYETHYLENE SMOOTH INTERIOR (SDR 35 OR SCH 40) WITH 8"x4" TEE (INSERTA TEES WILL BE PERMITTED) AT EACH DOWN SPOUT, MIN. 2 PER LOT AND CONNECTED TO CATCH BASIN AND CLEANOUT LOCATIONS AS SHOWN ON DRAWINGS.

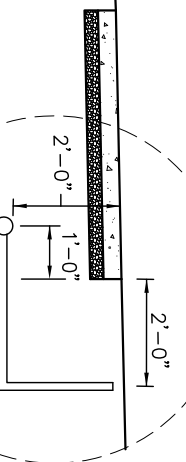

SIDEWALK

2'-0"

GROUND ELEVATION

6"

METAL SCREW PLUG WITH FLUSH FITTING CAP.

PLUG AS APPROVED BY THE CITY

45°

PROP. 8" SUMP DRAIN

STORM SEWER CLEANOUT DETAIL

REVISIONS:

DATE

APPROVED:
07-22-13

PAGE No.

600-16